

LINDE COMPANY DIV. OF UNION CARBIDE CORP.
"GREENVILLE PLANT, KEMET DEPT., LINDE COMPANY"

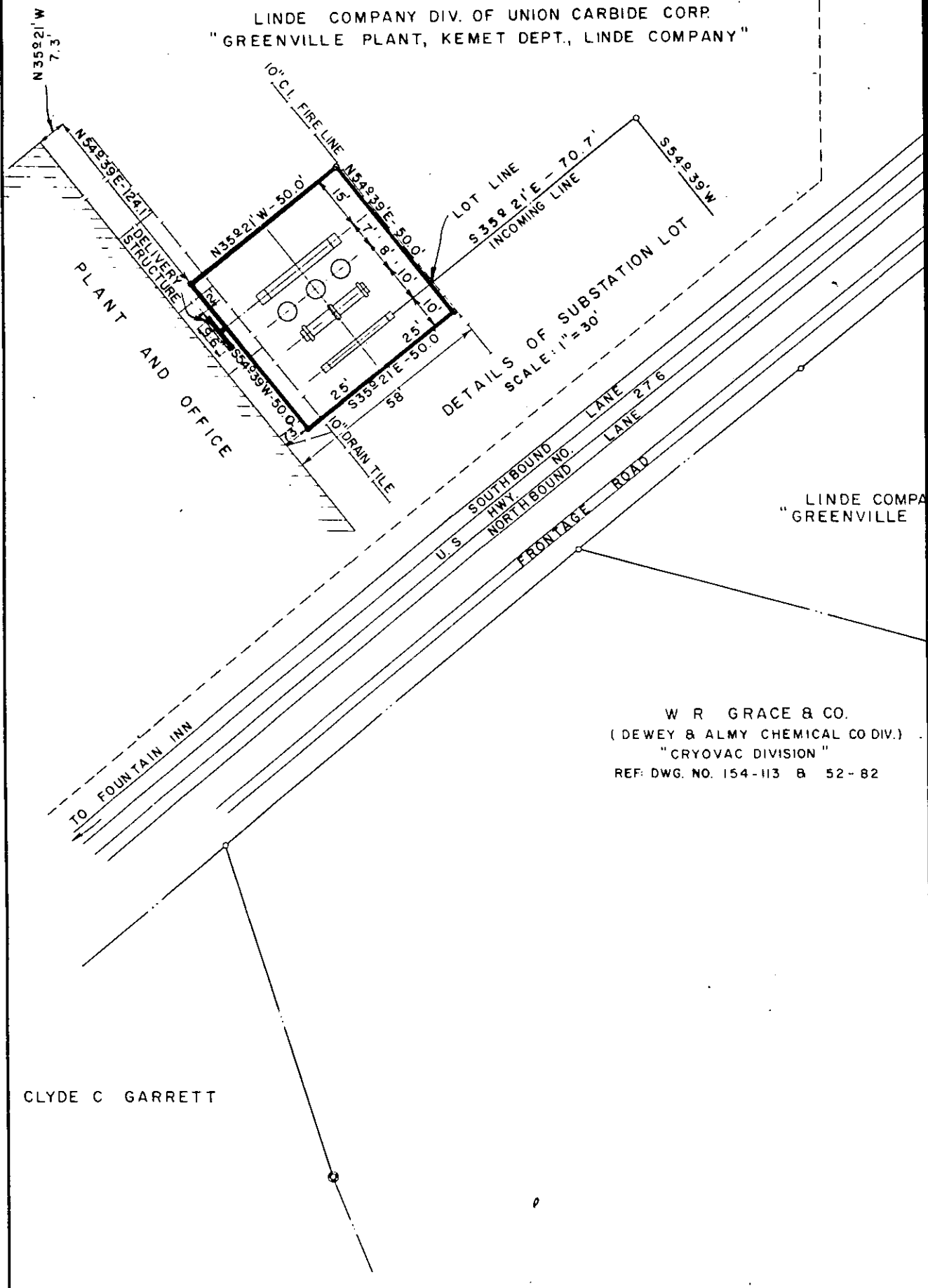

LINDE COMP
"GREENVILLE"

W R GRACE & CO.
(DEWEY & ALMY CHEMICAL CO DIV.)
"CRYOVAC DIVISION"
REF: DWG. NO. 154-113 B 52-82

CLYDE C GARRETT